



## Garage Door Industrial Sectional Door

---

Advanced sectional doors designed for the next generation

# Next-Generation Variable-Speed Sectional Door Operator

0.4kW/0.75kW/1.0kW

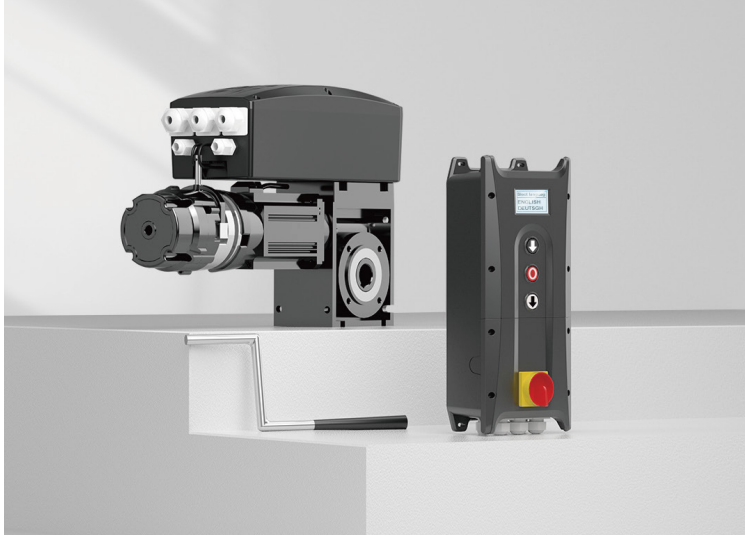

· Operator



· Control unit



· Cables

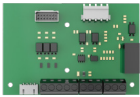

· Expansion board (optional)



· Main switch (optional)



· CEE plug (optional)



## German engineering, built to last



### Automatic calibration

Quick, hassle-free setup, allowing you to complete the setup within one minute



### Maximum door area up to 60m<sup>2</sup>

This door boasts the capability to open up to 60 square meters, offering significant advantages in terms of accommodating large spaces.



### LCD plain-text display

With 4-line LCD plain-text display, you could program easily and receive diagnostics when something is wrong.



### Smooth and precise speed control

Enhance your system with precise speed control for smooth, reliable, and efficient movement.



### Soft start, Soft stop

Smooth start/stop offers maximum material protection and long product life cycle.



### Accurate limit setting

Ensures the precise determination of operating endpoints, enhancing system performance and safety.



### Over-torque protection

Advanced torque monitoring system could measure the actual force and stop the door's movement when the door is caught in something or the spring breaks.



### Multiple safety inputs/outputs

You could connect several devices like safety edges, light curtains, photocells, radars, loop detectors and traffic lights etc.



### Protection class IP54 (IP65 available)

IP54 as standard, IP65 optional



### Gear heating system optional

It can be used in cold and harsh environment, down to -40°C



## Technical data

| Model                           | ENSV80 ISD                              | ENSV120 ISD | ENSV140 ISD |
|---------------------------------|---|-------------|-------------|
| Voltage                         | 1N~110-120VAC / 1N ~ 220-240VAC 50/60HZ |             |             |
| Motor Power (kW)                | 04                                      | 0.75        | 1.0         |
| Rated output torque (Nm)        | 60                                      | 100         | 120         |
| Max.output torque (Nm)          | 80                                      | 120         | 140         |
| Speed in RPM                    | 5-50                                    |             |             |
| Diameter hollow shaft (mm)      | 25.44 / 31.75                           |             |             |
| Endurance (c/h)                 | 60                                      |             |             |
| Waterproof and Dustproof Rating | IP54 (IP65 optional)                    |             |             |
| Limit setting of door travel    | Absolute encoder                        |             |             |
| Emergency release               | Chain hoist                             |             |             |
| Max.door area (m2)              | 25                                      | 49          | 60          |

## Safety accessories



Traffic lights



Ground loop



Radar

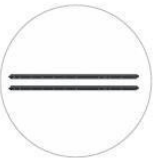

Light curtain



Safety edge



Photocell

# Ppgi & Panel

## PPGI diagram

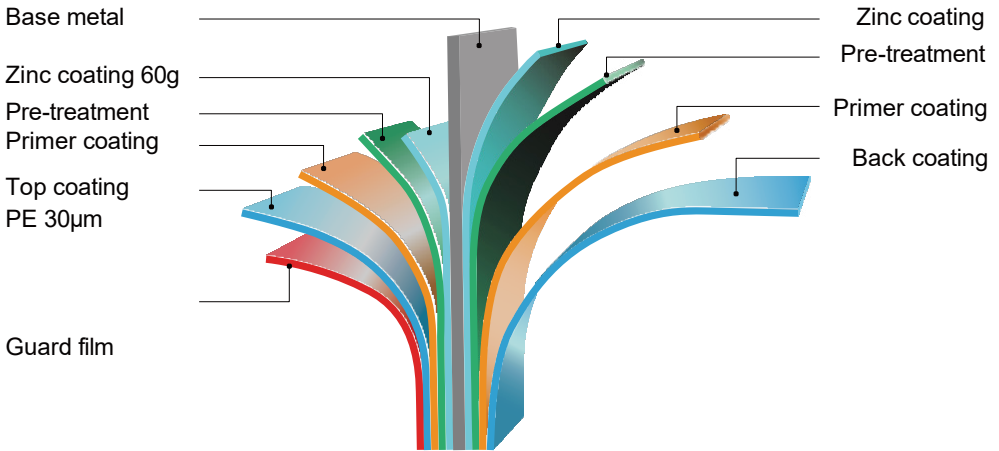

## Panel Structure

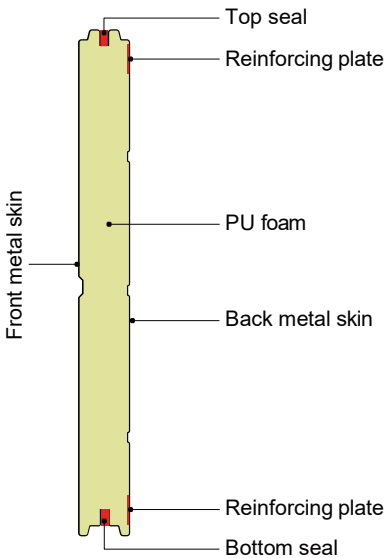

## Panel Jointing

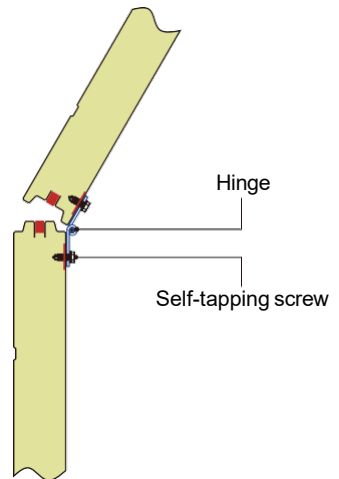

# Panel models

40mm finger-safe

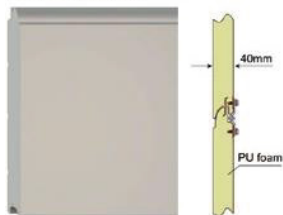

42mm

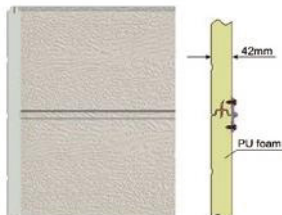

50mm

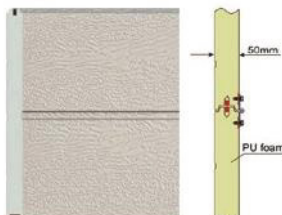

60mm

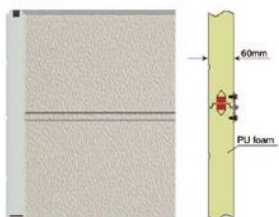

75mm

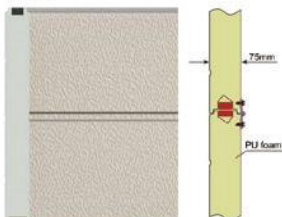

80mm

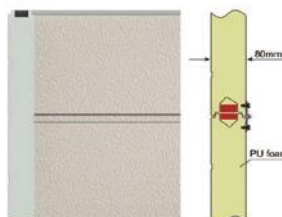

40+65 rib, finger-safe

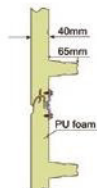

50+65 rib

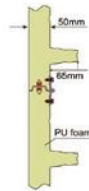

50+95 rib

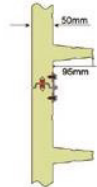

# Panel patterns

Top 1 line



Middle line



3 T lines



Top 2 lines



Middle V line



3 V lines



Fine ribs



4 V lines



Flat



Smooth



Cassette/Square



# Surface texture & Colors

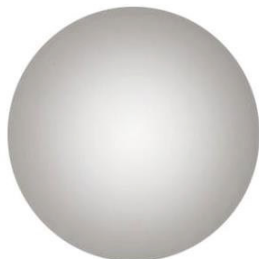

**Smooth**



**Woodgrain**



**Stucco**



**Wrinkle RAL7016**



**Black RAL9005**



**Silver RAL9006**



**Golden oak**



**White RAL9016**



**Dark walnut**



**Almond RAL1015**

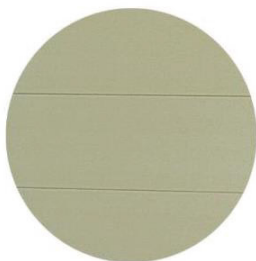

**Beige RAL1013**

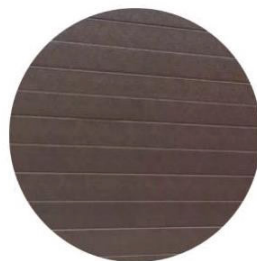

**Brown RAL8017**



# Installation effect

1 V-line



3 V-lines



Top 1 T-line



Top 2 T-lines



Middle 1 T-line



3 T-lines



Micro-rib



Flat



Cassette



Ranch



Smooth



Smooth with decoration





# Track types of garage door

Single track



Single track with vertical angle



Double track



Double track with vertical angle



Track set



The folding edge is designed to be finger-safe, and the seals are securely attached.

# Lifting way of industrial door

**Standard lifting**



**Vertical lifting without middle beam**



# Lifting ways of industrial door

Vertical lifting with middle beam



Door Hole Diagram

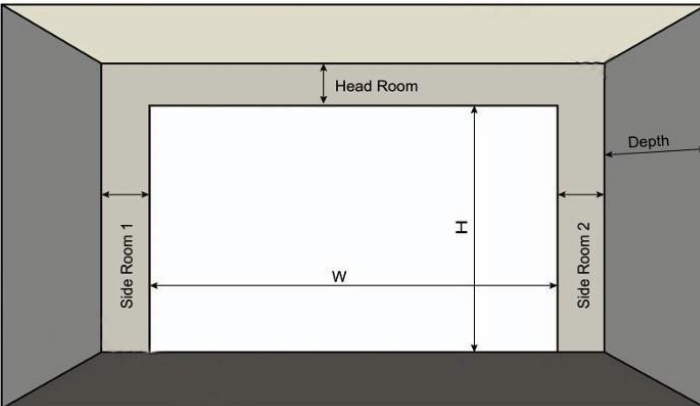

To be quoted properly  
These sizes should be  
informed accurately!

# Lifting ways of industrial door

**High lifting without middle beam**



**High lifting with middle beam**



# Windows

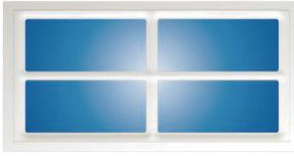

## UK & Europe



**Head Office**  
**Entrar Access Technologies UK LTD**  
124 City Road,  
EC1Y 2NX  
**London, United Kingdom**  
Call: +44 7949 265624  
England and Wales - CR: 06294297

## Middle East & Africa



**Entrar Access Technologies**  
GBC 2,  
Opposite to Old Airport Arrival Terminal  
**C Ring Rd, Doha, Qatar**  
Call: +974 4402 3014

**Entrar Line Trading L.L.C**  
Smartplace Business Center  
Level 2, The Iridium Building  
**Al Barsha, Dubai, UAE**  
Call: +971 5080 94464

## India & Far East



**Entrar Access Technologies India Pvt Ltd**  
No A-83, First Floor,  
Road No 2, Mahipalpur Extn  
**New Delhi, India**  
Call: +91 8310330566



